

CRANKSHAFT POSITION SENSOR

REMOVAL AND INSTALLATION

M1163003500332

Pre-removal and Post-installation Operation

- Timing Belt Lower Cover Removal and Installation (Refer to GROUP 11A, Timing Belt P.11A-33.)

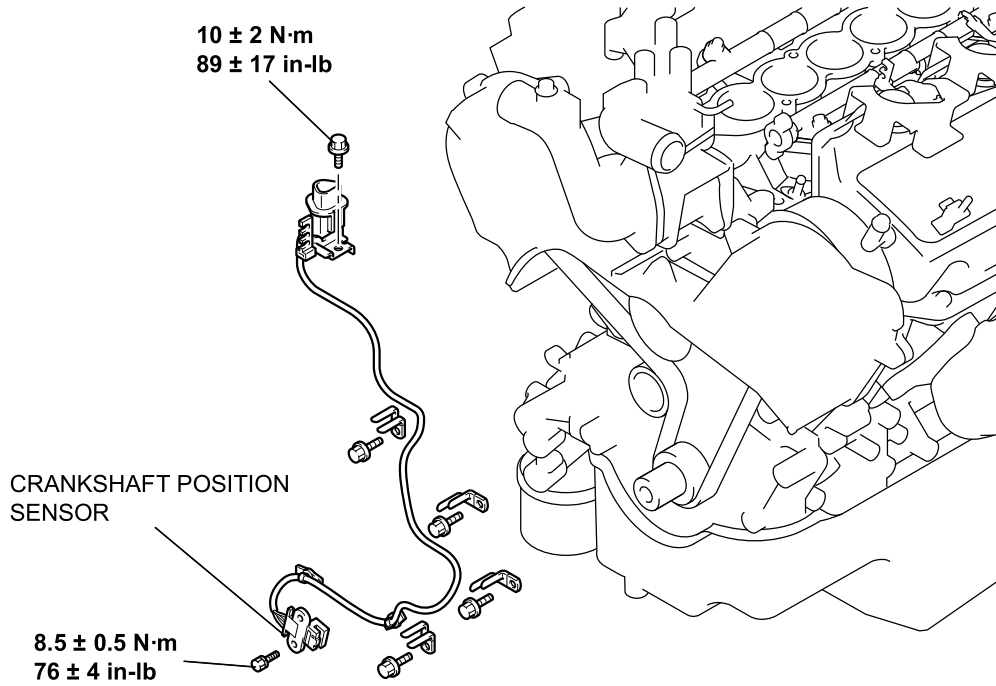

AC204073 AB

KNOCK SENSOR

REMOVAL AND INSTALLATION

M1163002800341

Pre-removal and Post-installation Operation

- Intake Manifold Removal and Installation (Refer to GROUP 15, Intake Manifold P.15-7.)

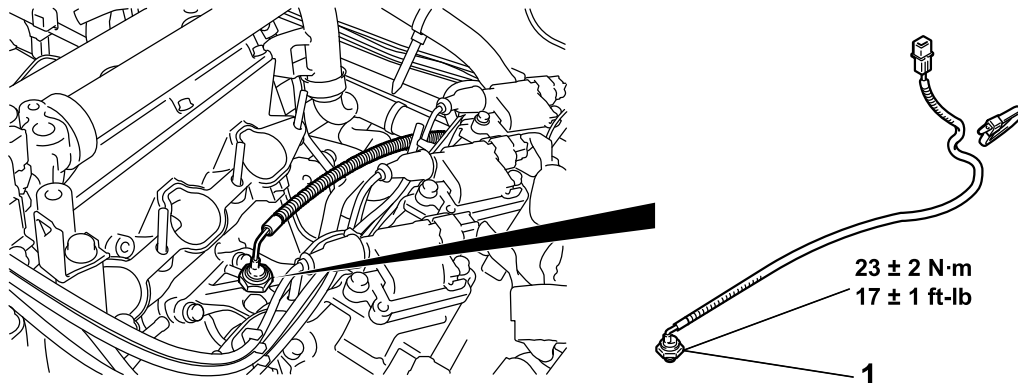

AC204095 AB

<<A>> >>A<< 1. KNOCK SENSOR

TSB Revision

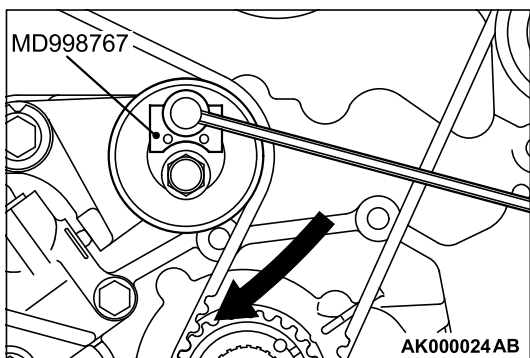
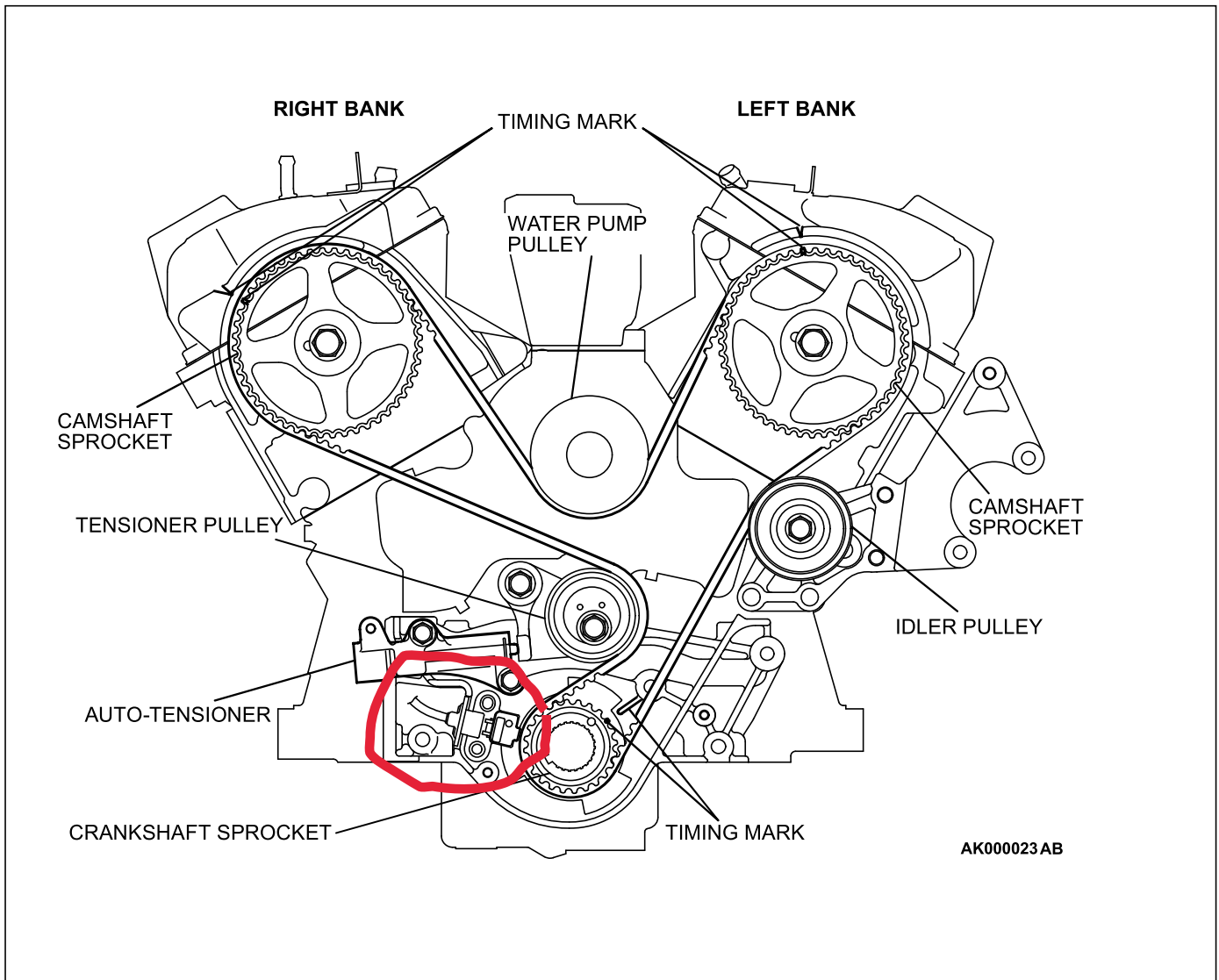

9. Mount special tool MD998767 and torque wrench on the tensioner pulley.

10. Torque it to 4.4 N·m (39 in-lb) with the torque wrench.

11. While holding the tensioner pulley in position, tighten the center bolt to the specified torque.

Tightening torque: 48 ± 6 N·m (35 ± 4 ft-lb)

12. Rotate the crankshaft two turns clockwise and leave it alone for approximately five minutes.