

CLUTCH

REMOVAL AND INSTALLATION

M1212001001322

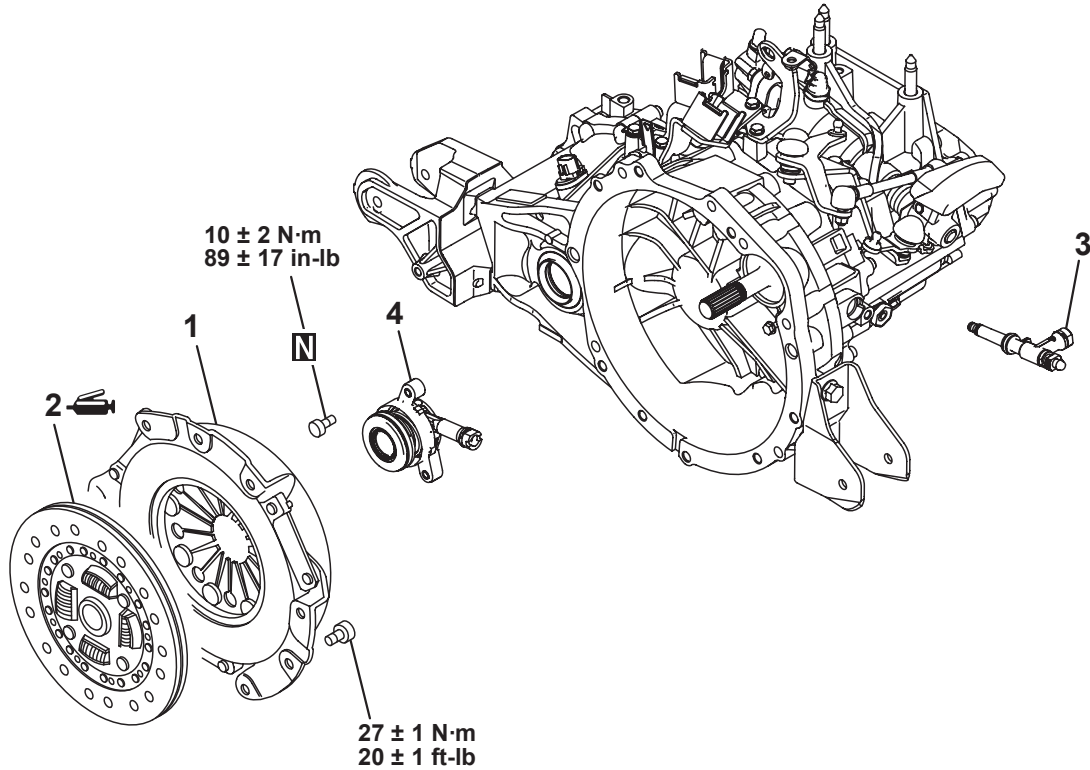

AKA00032AC

Removal steps

- >>B<< 1. Clutch cover
- >>B<< 2. Clutch disc

Removal steps (Continued)

- >>A<< 3. Concentric slave cylinder adapter
- >>A<< 4. Concentric slave cylinder