

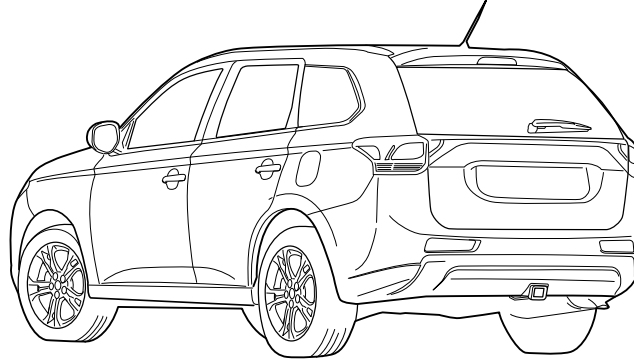

OUTLANDER TOW HITCH MZ314710 INSTALLATION MANUAL



Make sure to follow the instructions in this manual for proper installation.

Attention

- This manual gives precautionary instructions with the following symbols:

 **Warning** /  **Caution** These symbols indicate a particularly important safety instruction. Read and follow carefully for your safety. Failure to heed the caution may result in human injuries or accidents.

 **Note** This symbol indicates an advisory instruction to follow during installation.

- The initial installation quality determines the level of performance, durability, and trouble occurrence in the future. Make sure to read the following instructions carefully beforehand for proper installation.
- Failure to follow these instructions not only prevents the product from working properly but may also lead to trouble with the vehicle. Do NOT attempt installation other than instructed in this manual.
- Mitsubishi Motors Corporation does not assume responsibility for any defects or difficulties caused by or resulting from failure to follow given instructions.
- We strongly recommend you to have installation performed at an authorized Mitsubishi Motors dealer.

TOOLS:

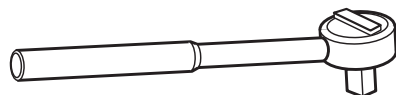

Ratchet

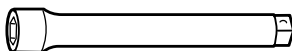

6" Extension

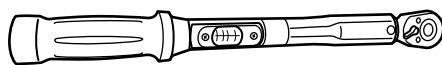

Torque Wrench



Scissors

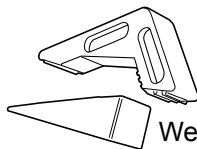

Wedges



10mm, 12mm
13mm, 14mm &
19mm Sockets

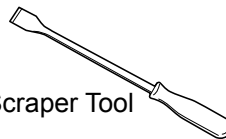

Scraper Tool

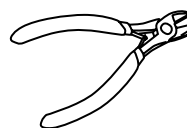

Diagonal Cutters



Masking Tape



#2 Phillips Screw Driver

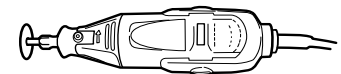

Rotary Tool

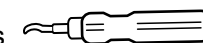

Deburring Tool



1/2 Round File

BILL OF MATERIALS:

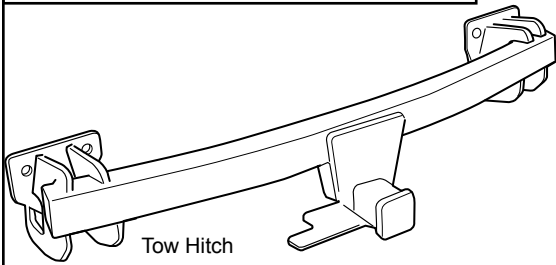

M12 Bolt
(4 ea)

M12 Conical Washer
(8 ea)

Convuluted Tubing
(2 ea)



M8 Bolt
(6 ea)

M8 Conical Washer
(6 ea)

M12 Nut
(4 ea)

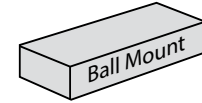

Ball Mount Box
(Ball Mount, Ball, Pin, & Clip)

Installation Precautions

- Make sure to refer to safety reminders (⚠ Danger ⚠ Warning ⚠ Caution) in the manual during installation. Failure to follow these instructions (⚠ Danger ⚠ Warning ⚠ Caution) could result in malfunction of the product and/or the vehicle.
- Organize removed tapping screws, bolts, nuts, etc. part by part to avoid loss when disassembling vehicle parts and make sure that all the parts are restored to their original position after installation work. Treat the vehicle and removed parts with special care to keep them from damage.

Before Installation

- Be sure to disconnect the negative terminal cable from the battery.



When Installing or Removing Parts

- Loosen or tighten bolts and nuts with a tool that matches their size.



- Use a Phillips screwdriver that matches the recess in the screw head.



- To remove plastic parts, use a trim remover.



Wiring

- When disconnecting connectors, first unlock them. Then separate the connectors by pulling on them, not on cables.



- When connecting connectors, push them against each other until the lock clicks.

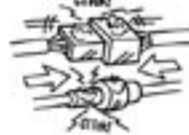

- Do not pull on wiring harnesses strongly.



- Do not let harnesses be pinched between parts.



- Route harnesses away from hot components such as the engine and the radiator.



- Protect harnesses from sharp edges by covering the edges with tape or other suitable materials.



- Apply sealant to grommets at portions where harnesses run through.



- Do not fasten harnesses to brake pipes or high pressure air conditioner pipes.



Clamping Harness

- Fasten excessive harnesses to existing vehicle harnesses with tape or cable ties.



- For harness protection, cover bare harnesses with vinyl tape before binding them up.

- Bind up extra length of harnesses using a cable tie.

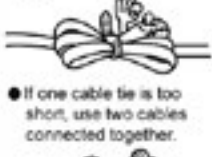

- If one cable tie is too short, use two cables connected together.



After Installation

- Check the product and wiring for installed condition before connecting the cable back to the battery.



- Check the installed product for function. Also check lamps, horn, wipers, etc. for proper operation.



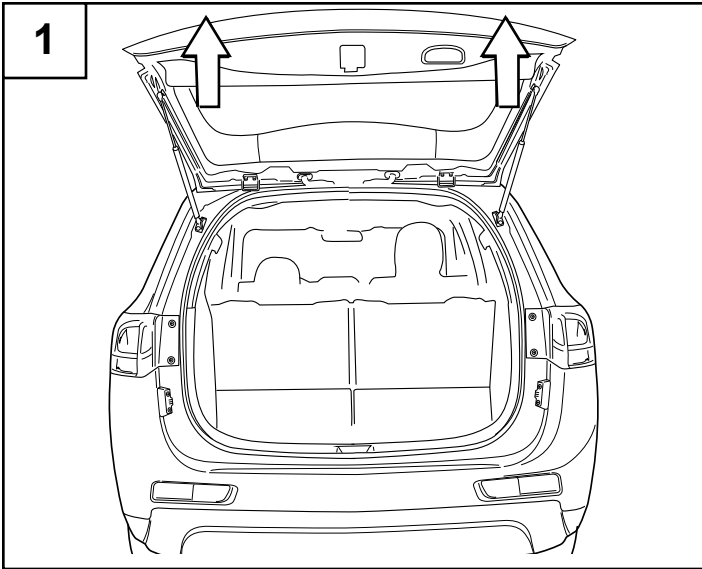

1
Open the trunk first.

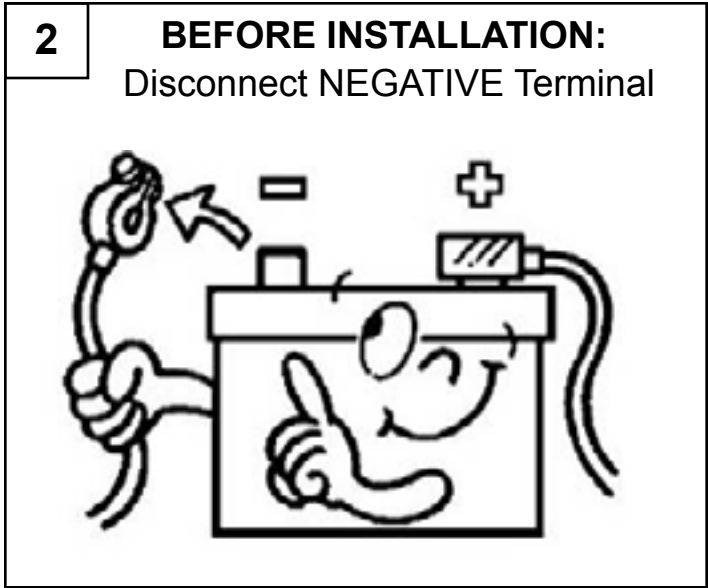

2 **BEFORE INSTALLATION:**
Disconnect **NEGATIVE** Terminal

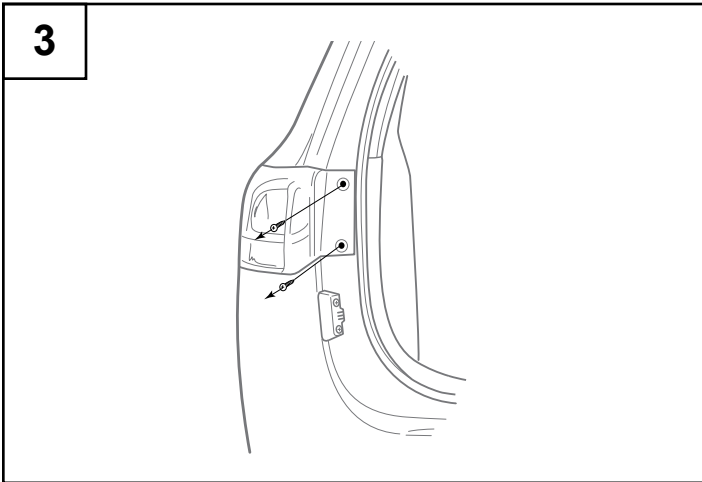

3
Remove and save tail lamp screws. Repeat for passenger side.

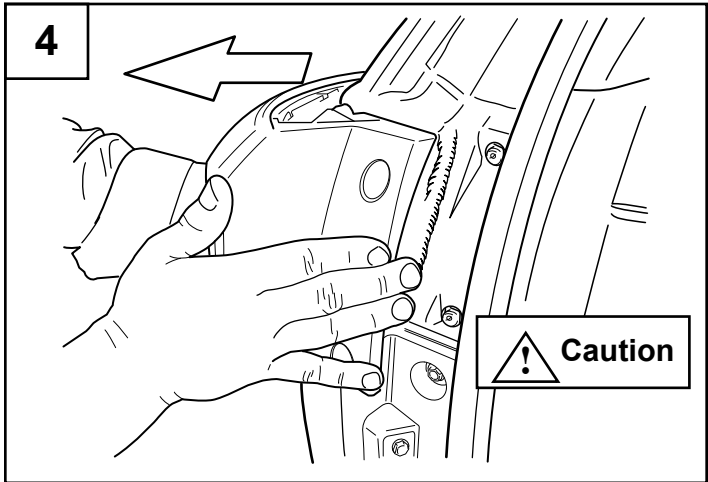

4
Caution: Carefully disengage tail lamp assembly clips by pulling towards the rear of vehicle. **DO NOT use trim removal tool around tail lamp edge.** Repeat for passenger side.

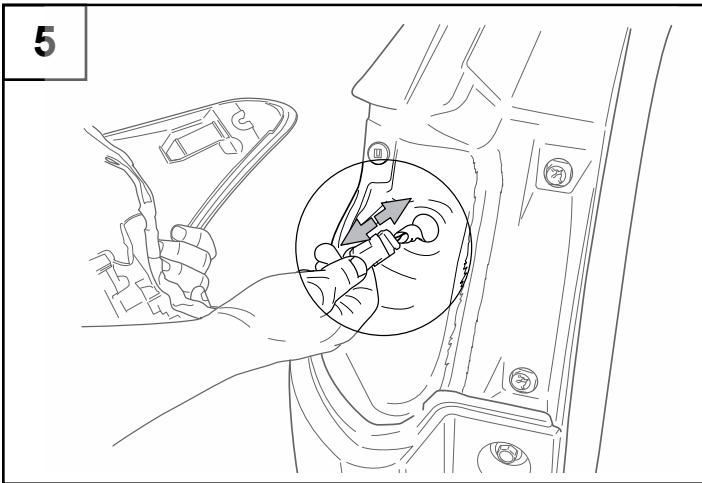

5
Unseat tail lamp harness grommet and pull connectors out far enough to disengage connectors. Repeat for passenger side.

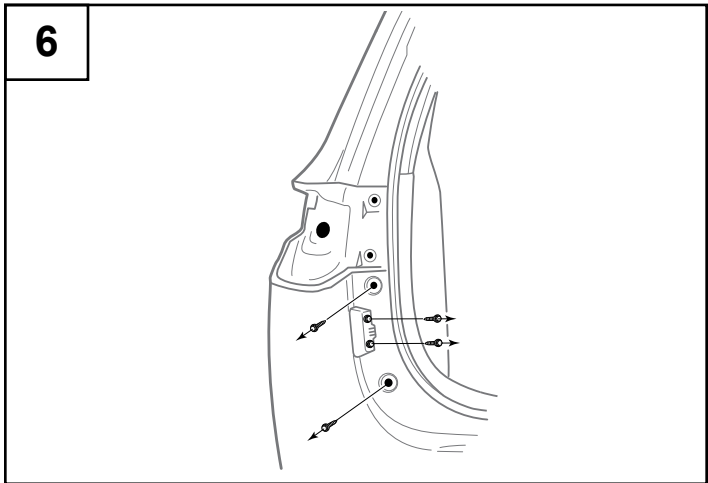

6
Remove and save fascia bolts on both driver and passenger side.

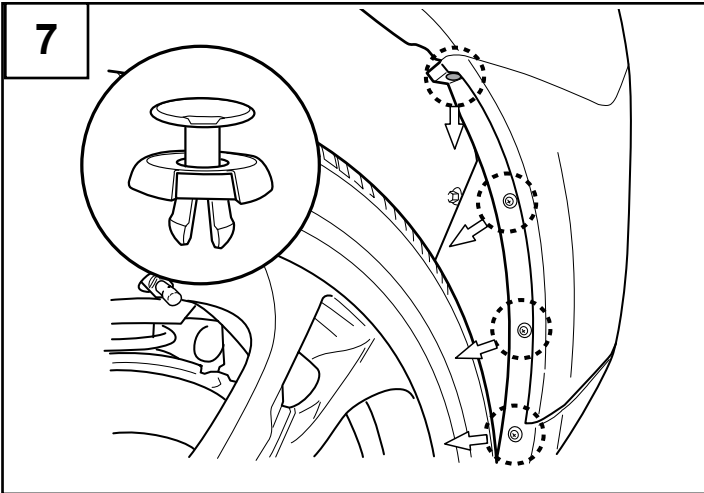

7 Remove and save the four (4) fascia clips at the edge of both wheel wells.

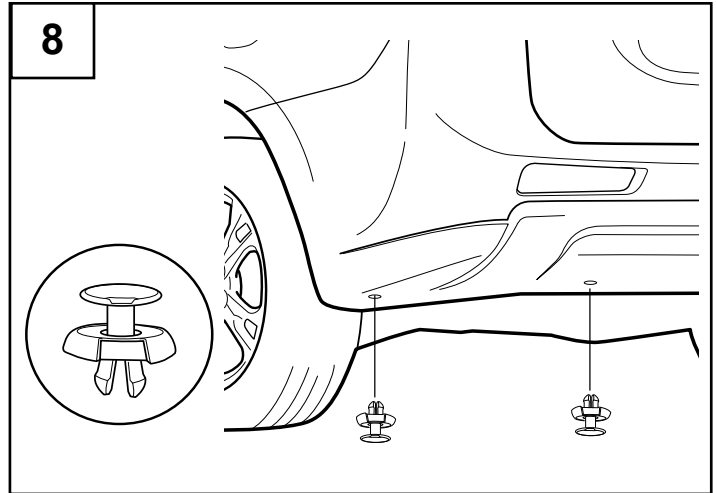

8 Remove and save the two (2) fascia clips located underneath the corner of the rear of vehicle on both driver and passenger side.

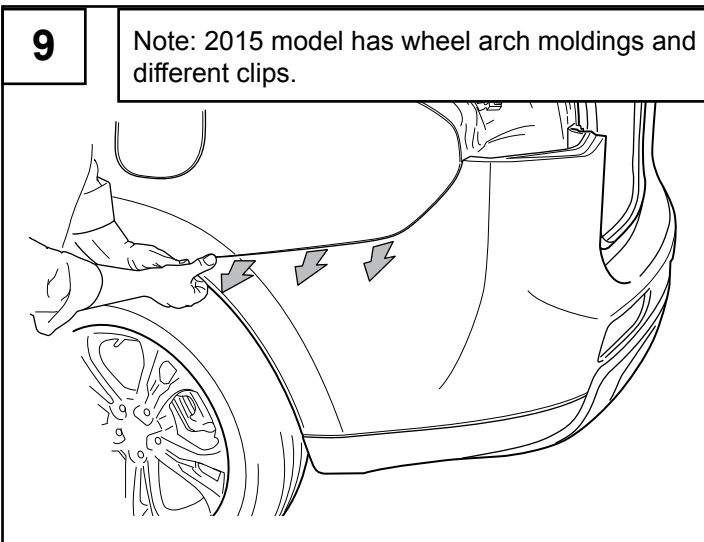

9 Note: 2015 model has wheel arch moldings and different clips.

Carefully disengage clips of the both of rear quarter panels.

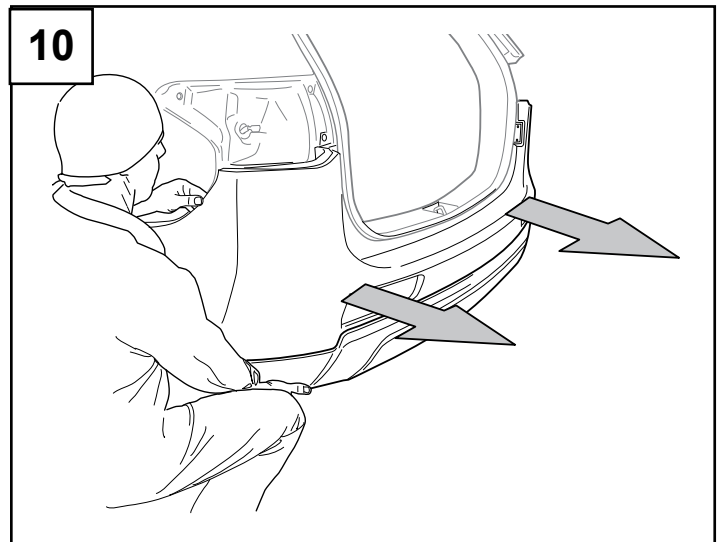

10 Carefully remove rear bumper fascia.

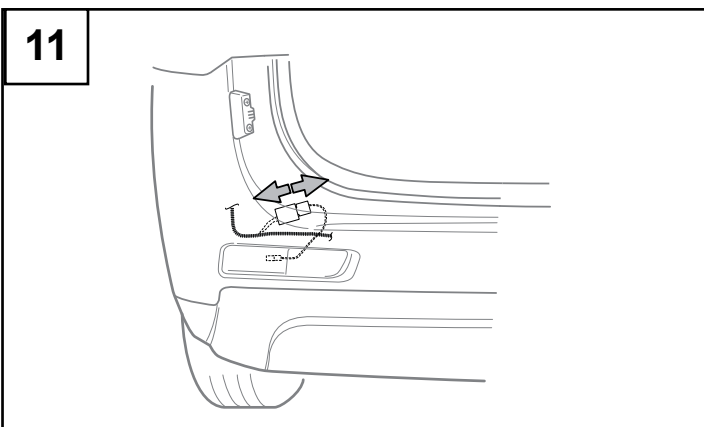

11 Disconnect the backup lamp power harness located on the inner side of the bumper fascia at the driver side. Disconnect the rear park assist if present.

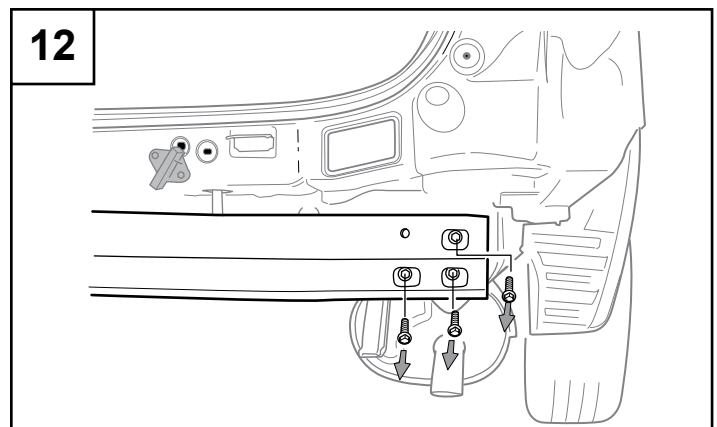

12 Remove and discard the three (3) 12mm bolts bumper support bolts on both the driver and the passenger side. Remove and discard the bumper support.

! **Caution:** Protect the bumper fascia by covering with tape or securing it in a protective location.

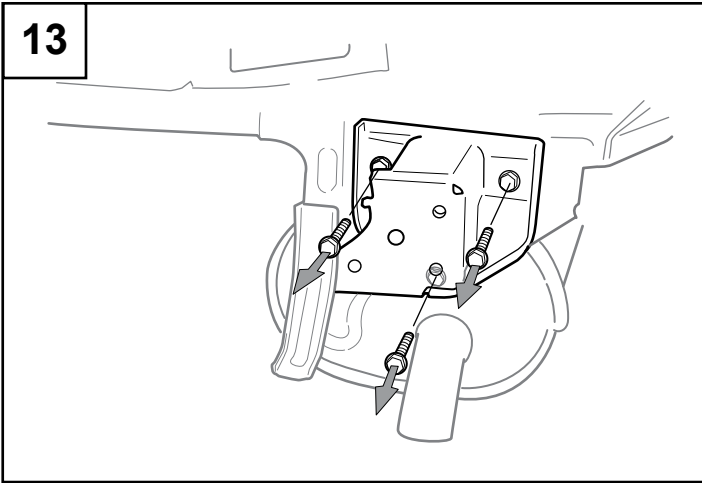

Remove and discard the three (3) 12mm bumper support bracket bolts on both the driver and passenger sides. Remove and discard bumper support brackets.

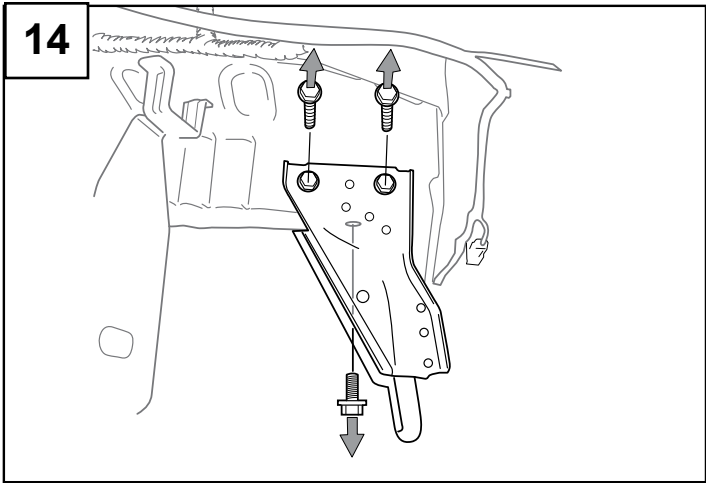

Remove and discard the three (3) 14mm bolts of the vehicle tie down and remove and discard vehicle tie down.

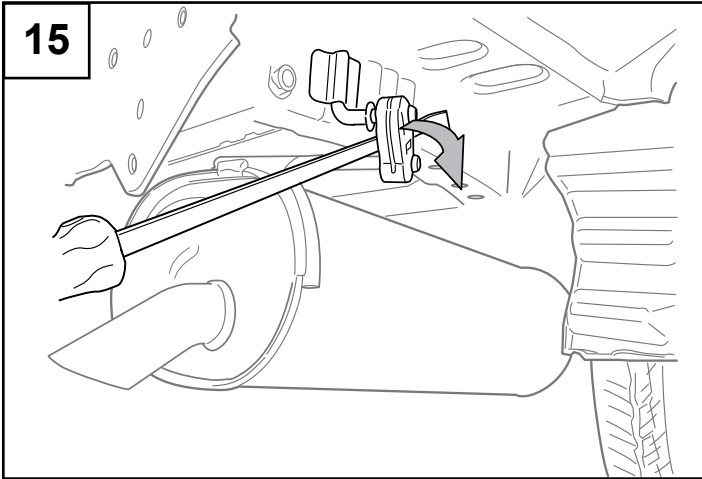

Using a long pry bar or a hanger removal tool, disconnect the muffler from the two muffler hanger pins.

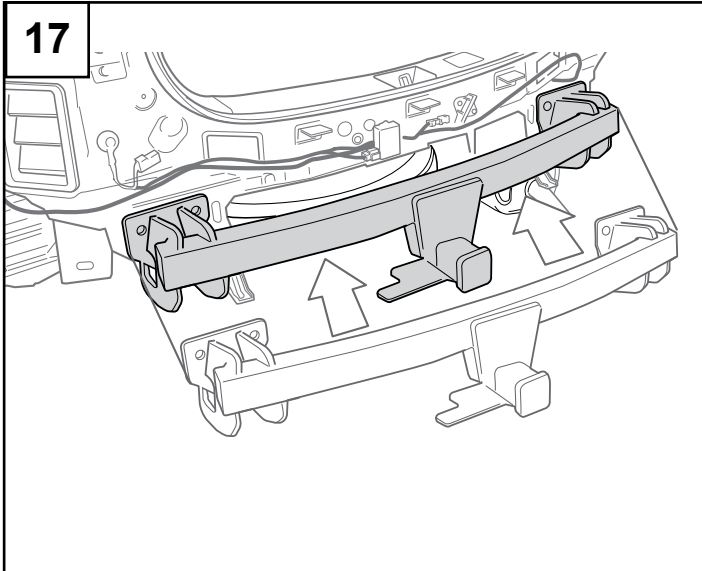
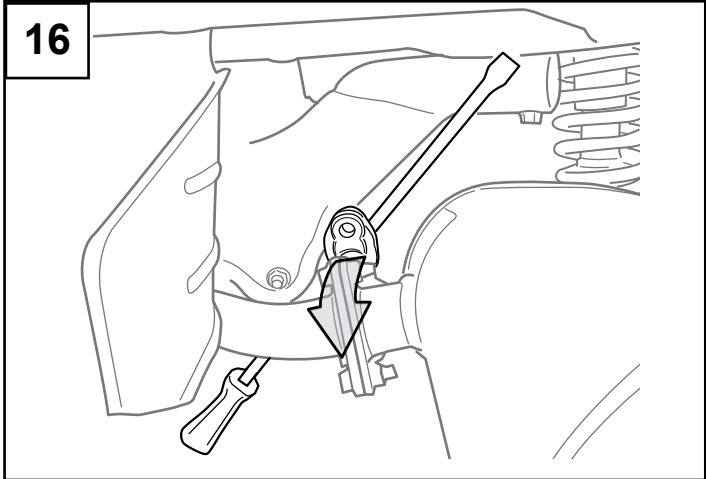

Position hitch up to vehicle.

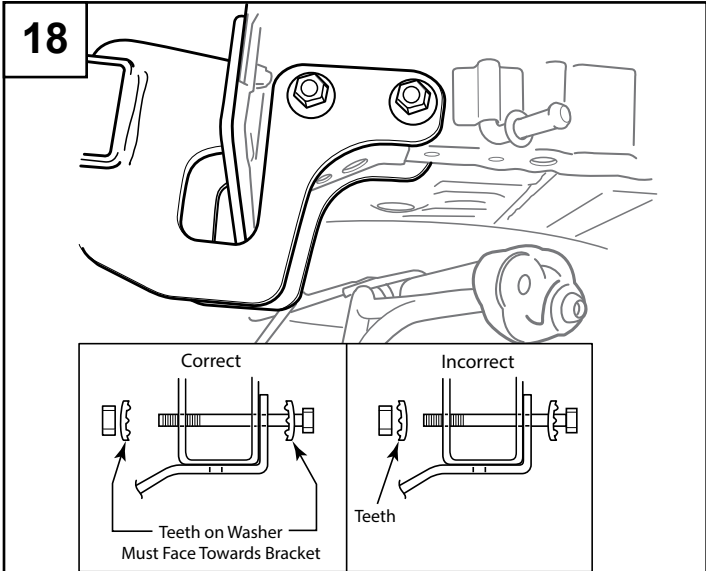

Install hitch and hand tighten the four (4) M12 bolts, conical washers and nuts.

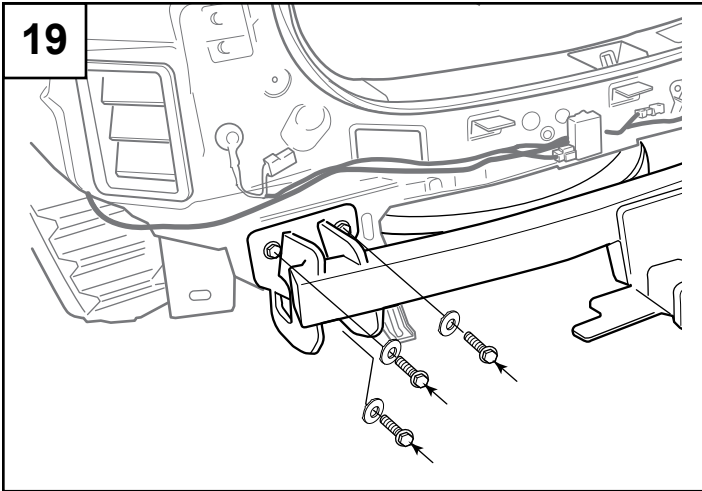

Insert the M8 bolts and conical washers on both driver and passenger sides as shown and hand tighten.

Using a torque wrench and sockets, torque all hardware as specified: M12 Bolt 75 - 80 lb-ft (101 - 108 Nm)
M8 Bolt 22 - 27 lb-ft (27 - 34 Nm)

2014 Model Year

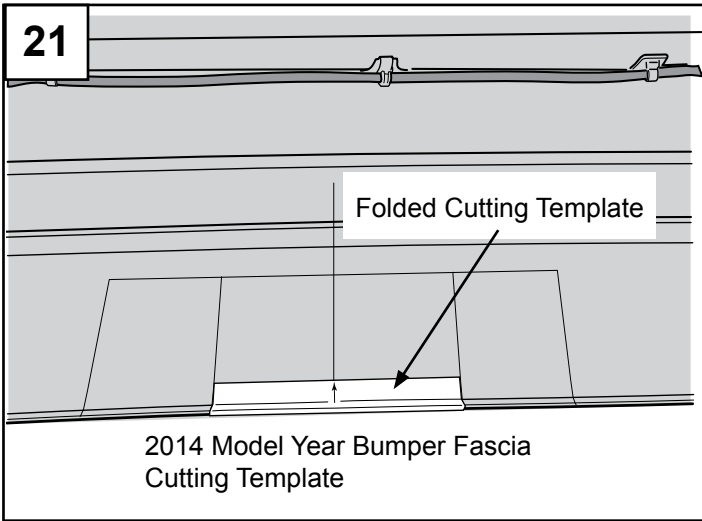

Align the cutting template to the inside of the bumper fascia, at the center line, as indicated on the template. Fold the template on the lower fold line and wrap the the template to the out side of the bumper fascia.

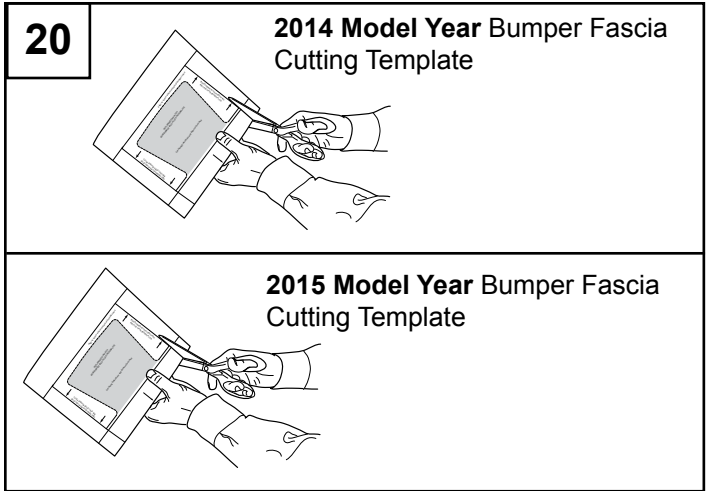

Locate the correct model year, rear bumper fascia cutting template in the instructions and cut down to the size as marked.

2014 Model Year

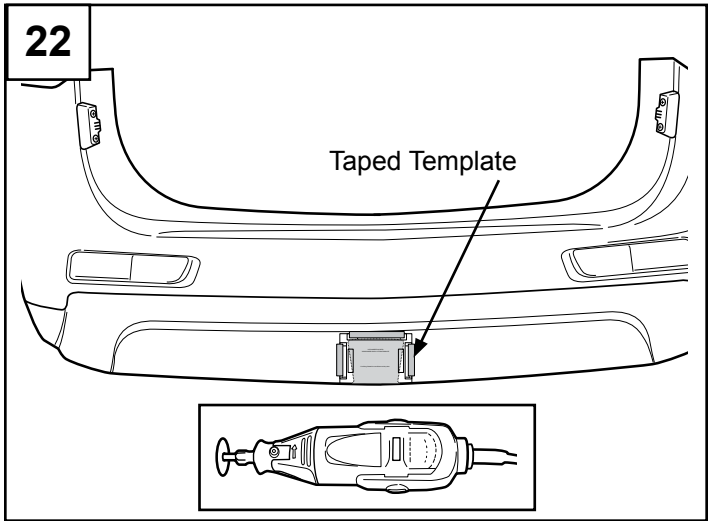

Using a rotary tool, cut out the inner portion of the cutting template. Clean edges with a file or deburring tool.

2015 Model Year

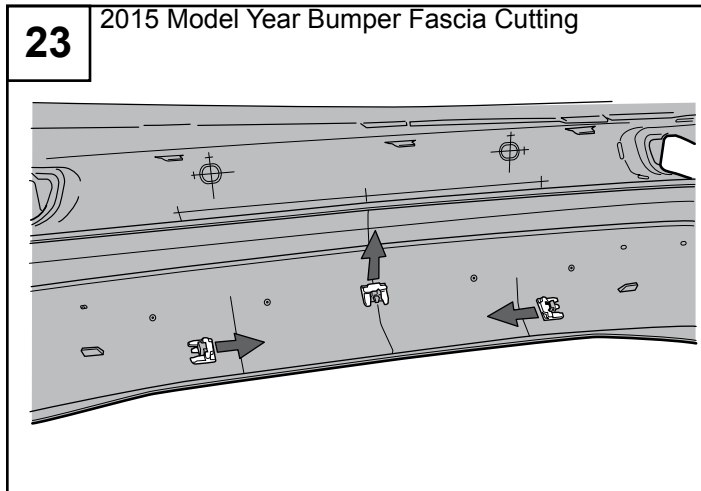

Remove Clips from inside the bumper fascia.

2015 Model Year

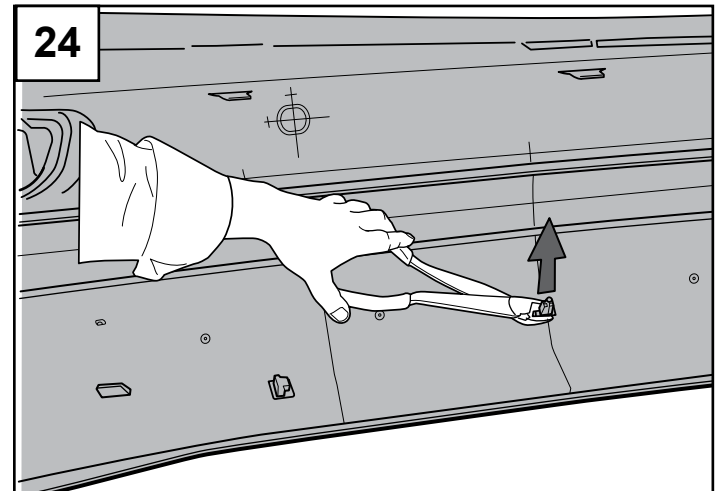

Trim the top of the center clip .

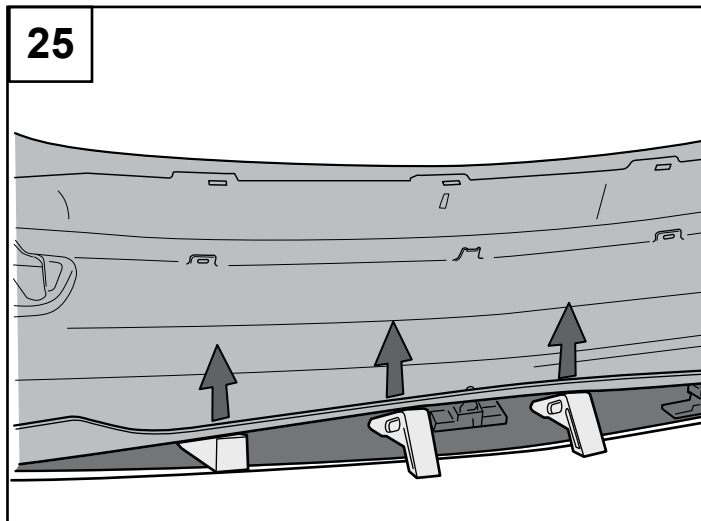

Insert wedges to lift the inner bumper fascia from the bumper cap.

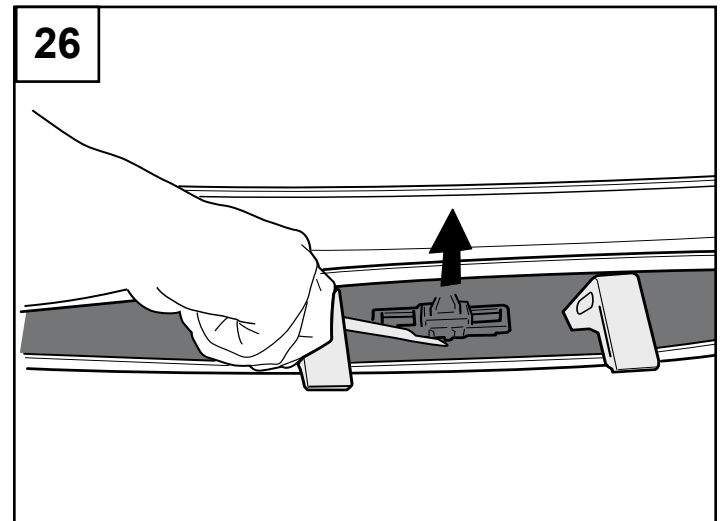

Remove the base of the center clip completely from the bumper cap and discard.

! CAUTION !
To avoid damage to the exterior of the bumper cap.
DO NOT TWIST the scraper when prying off the center clip base.

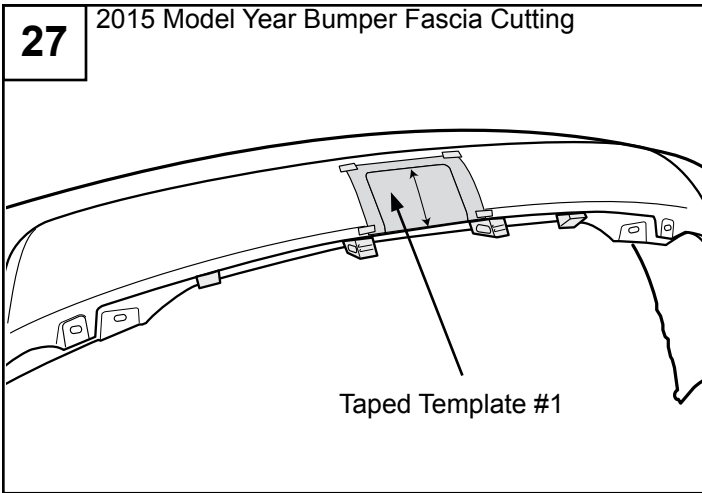

Align the cutting template to the bumper fascia, cap using the center line, as indicated on the template and tape it in place.

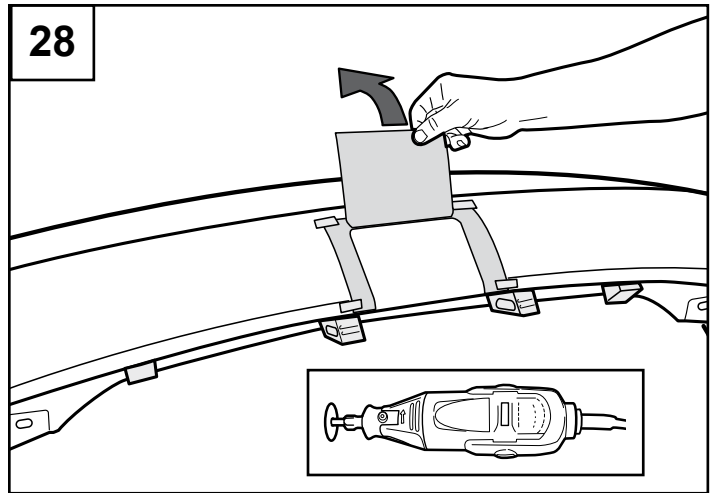

Lift the cut out from the template and mark the cut lines. Using a rotary tool, cut out the inner portion of the cutting template. Clean edges with a file or deburring tool.

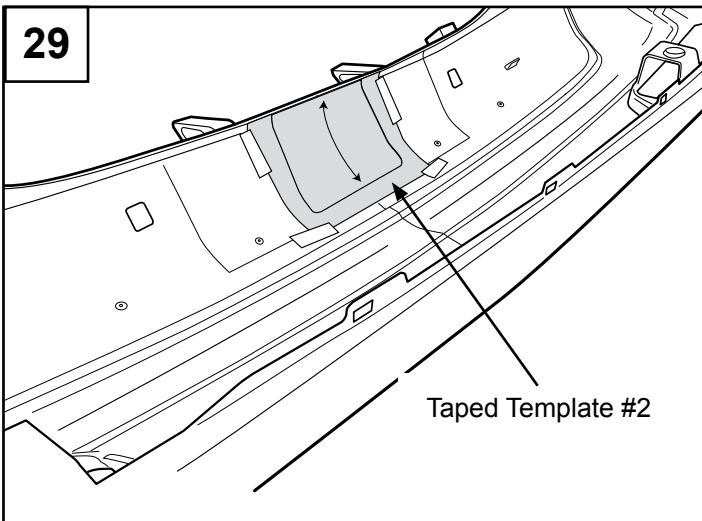

Align the cutting template to the inside of the bumper fascia, at the center line, as indicated on the template and tape it in place

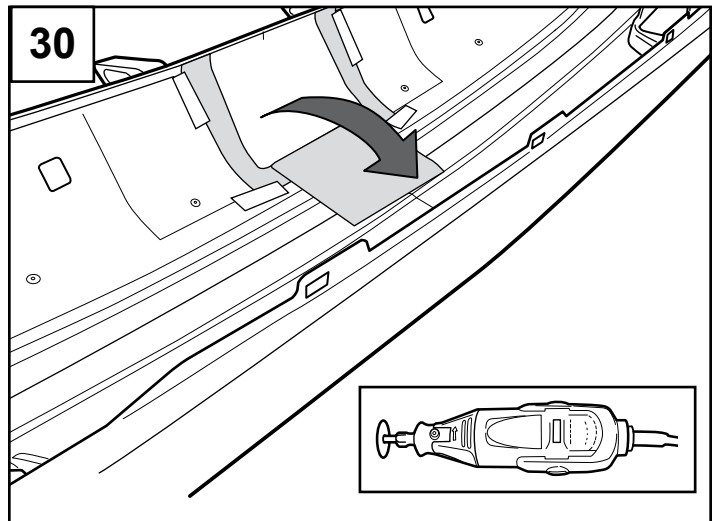

Lift the cut out from the template and mark the cut lines. Using a rotary tool, cut out the inner portion of the cutting template. Clean edges with a file or deburring tool and remove wedges.

CAUTION: Do not cut through the bumper fascia cap.

31

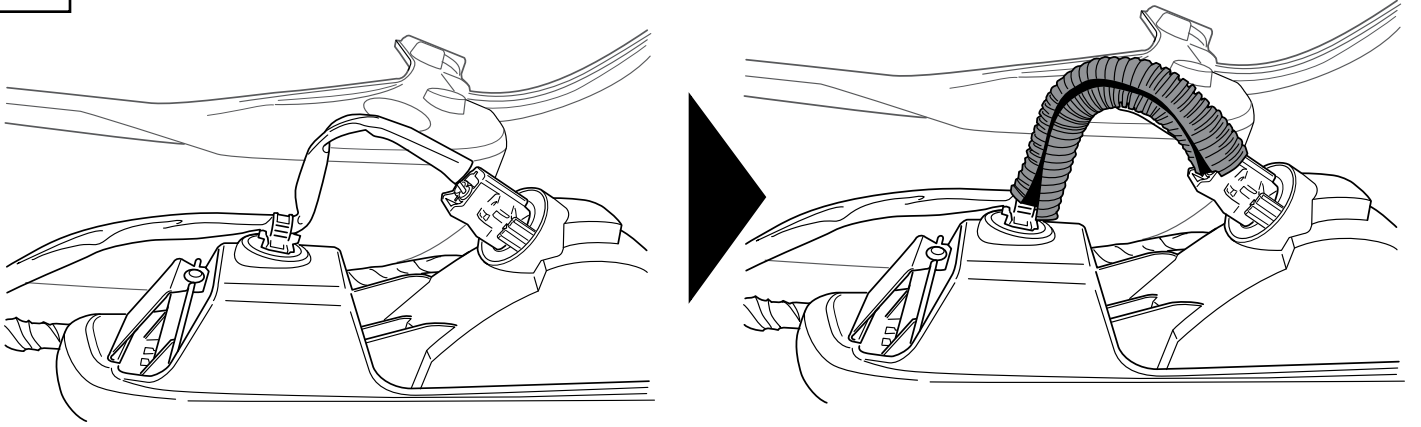

Prior to reattaching bumper fascia to the vehicle, locate the two (2) pieces of convoluted tubing in the hitch kit and attach to backup light wire harness as shown. Repeat for both driver and passenger side of bumper fascia.

32

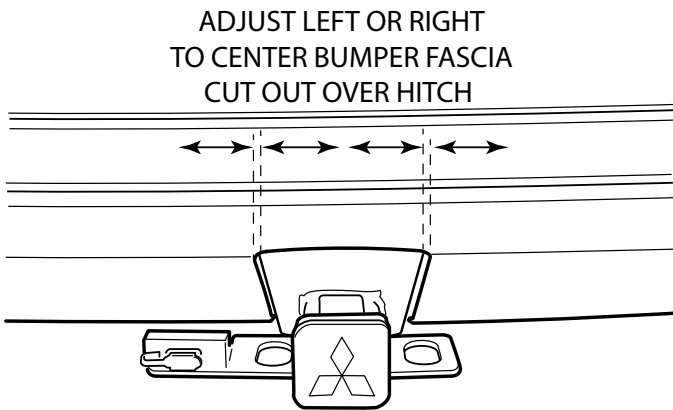

Prior to fastening the rear fascia, make sure to balance the cut out section to tow hitch as shown.

33

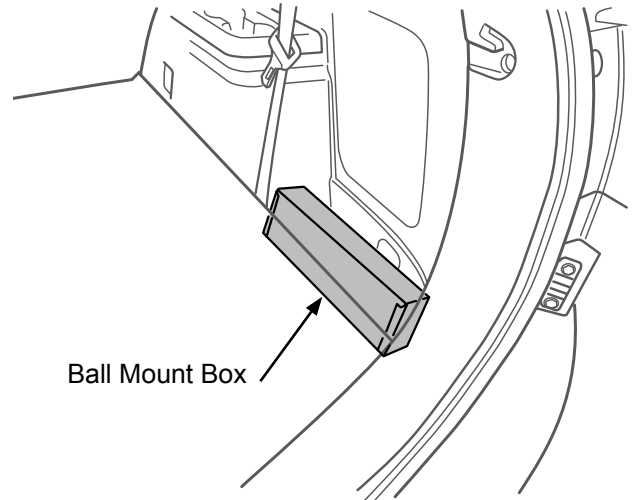

REMEMBER, when you're done:

- 1) Verify brake lights, tail lights and back up lights are functioning (and rear park assist if equipped).
- 2) Re-set the vehicle audio systems presets.
- 3) Place Ball Mount box in the rear passenger cargo area.

34

If the vehicle is equipped with Rear Park Sensors, before final reassembly, mount the bumper fascia up to the vehicle, temporarily reconnect the battery, start the engine, set the parking brake, put the transmission in Reverse and confirm the system sounds off with an object within 3 feet of the fascia.

Then turn the engine off, disconnect the battery and continue with re-assembly working the following steps in reverse from disassembly.

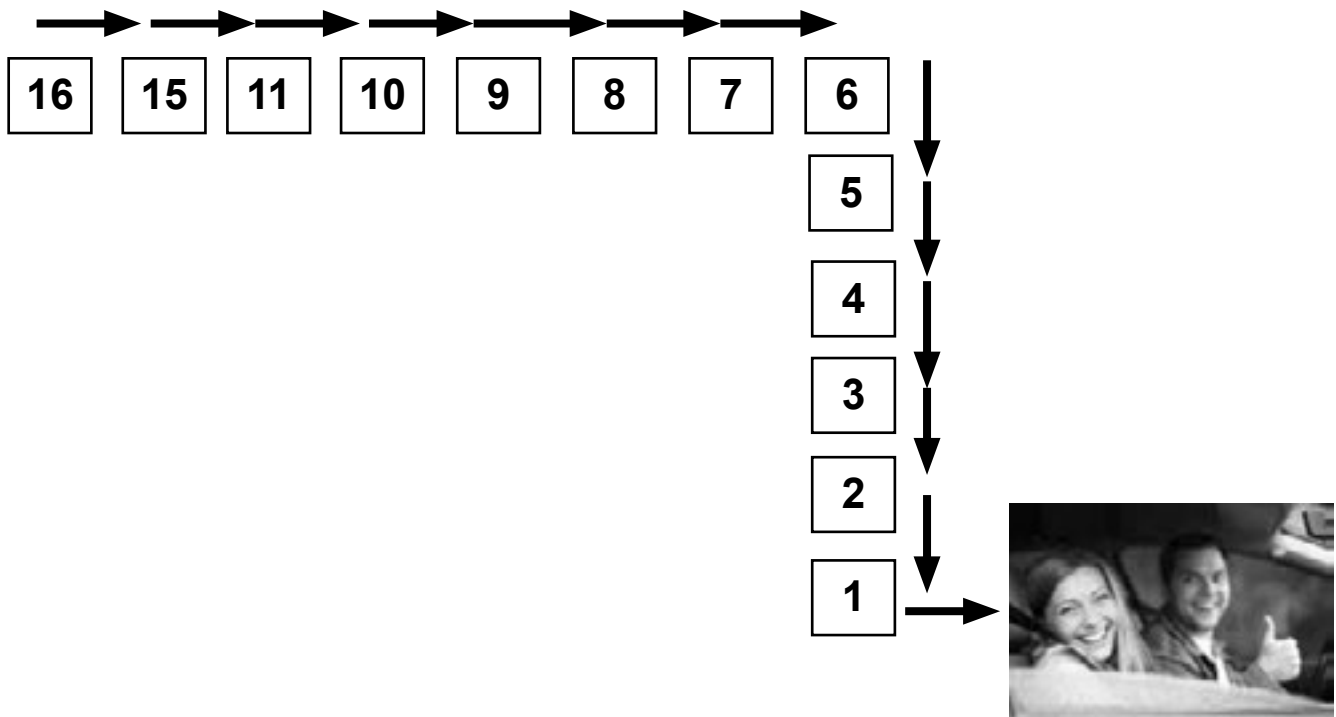

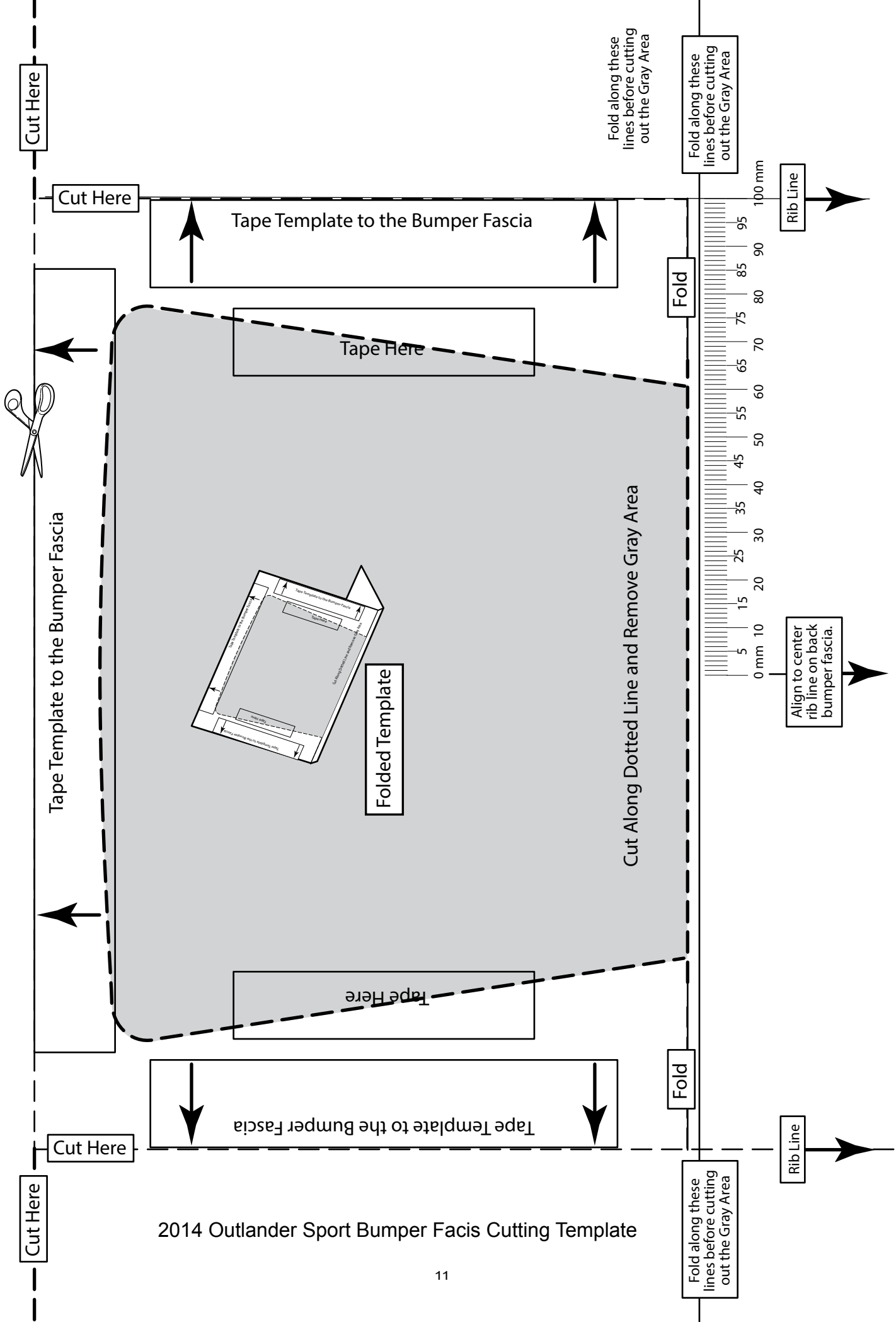

2014 Outlander Sport Bumper Facis Cutting Template

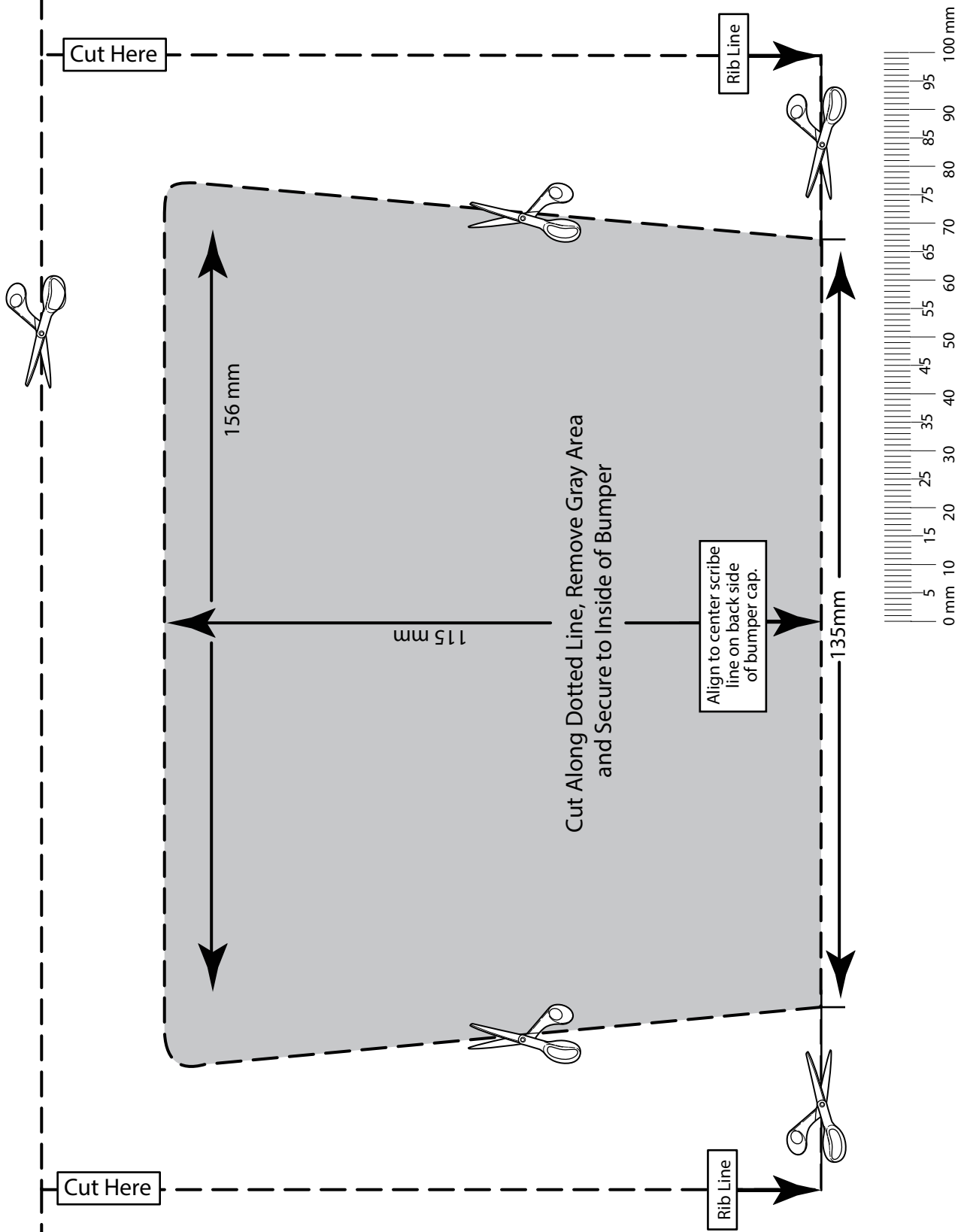

2015 Outlander Inner Bumper Fascia Cutting Template

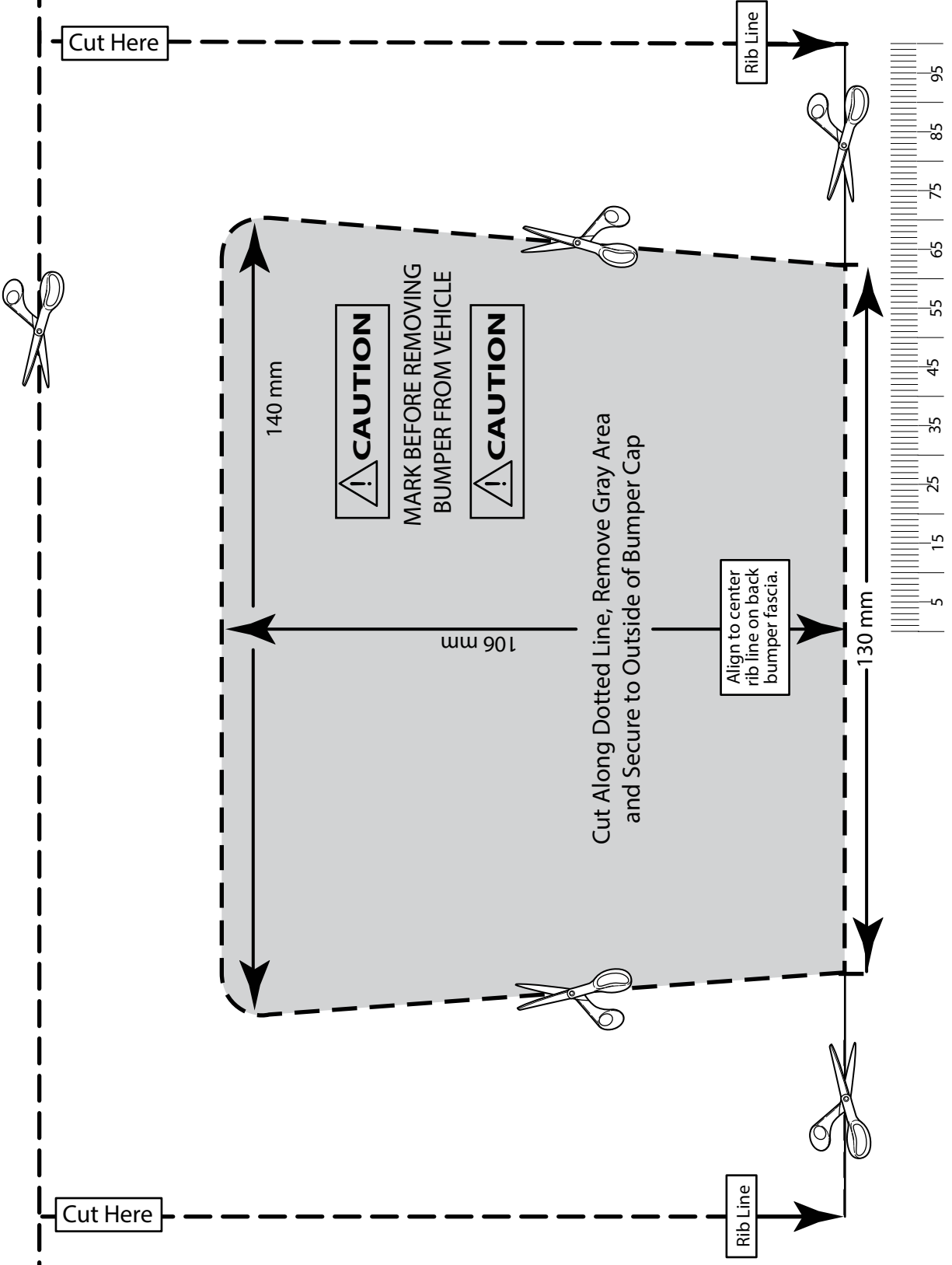

2015 Outlander Outer Bumper Cap Cutting Template

MITSUBISHI MOTORS
GENUINE PARTS

**TO THE CUSTOMER
HANDLING INSTRUCTIONS**

OUTLANDER

HITCH

MZ314710

Thank you for purchasing the Mitsubishi Genuine Accessory.
Read this publication carefully to ensure correct use of the product in the best condition with proper knowledge of it.

Attention

- 1) If there is anything unclear about the usage of the product, contact your Mitsubishi Motors dealer for clarification.

Caution

- Never modify the product
- Mitsubishi Motors Corporation is not responsible for any defects or difficulties caused by or resulting from the failure to follow given instructions.
- **Ball Mount shall be removed from the hitch when a trailer is not towed.**

- 2) Please refer to vehicle owner's manual to obtain vehicle towing capacity.

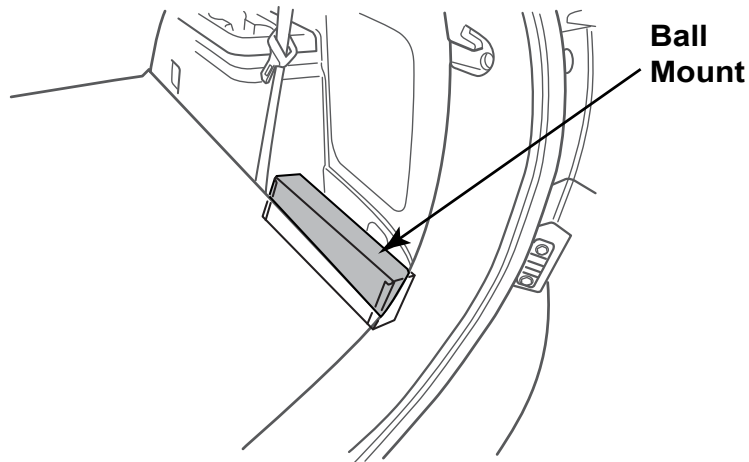

 **MITSUBISHI MOTORS**